

## FS58 Thin Sheet Nutsert

Steel · Large flange · Round · Closed end  
M4 - M8

### Features

- Designed to provide load bearing threads in thin sheet materials
- Large flange head provides a load bearing surface and reinforces the hole to prevent push-out
- Closed end prevents the ingress of dirt and fluids into thread and electrical circuits

### Material

- Low carbon steel, zinc plated, clear trivalent passivated  
(DIN EN 10263-2 Qst 34-3, BS EN/DIN 10263-2 C8C, Werkstoff 1.0213, SAE 1008)

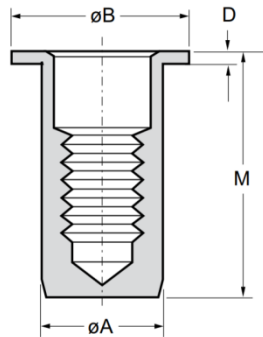

Before Placement

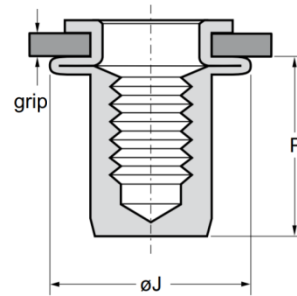

After Placement

Part No.	Thread Size	Grip Range		Hole Size	øA	øB	D	øJ	M	P
		min.	max.	+0.1 / -0	max.	max.	max.	max.	max.	max.
0FS58-70421	M4 x 0.7	0.50	2.50	6.10	6.05	9.30	0.80	10.50	16.64	12.10
0FS58-70522	M5 x 0.8	0.50	2.50	7.10	7.05	10.30	1.00	13.30	17.56	12.30
0FS58-70628	M6 x 1.0	0.50	3.00	9.10	9.05	13.30	1.50	15.00	22.48	16.00
0FS58-70832	M8 x 1.25	1.00	4.00	11.10	11.05	14.30	1.50	18.60	25.84	19.80

Thread Size	Max. torque	Pull-out	Torque-to-turn	Push-out
	Nm max.	kN	Nm min.	kN
M4 x 0.7	5.1	5.5	1.5	2.9
M5 x 0.8	7.9	8.0	3.0	4.2
M6 x 1.0	12.4	10.8	3.4	6.5
M8 x 1.25	16.4	12.5	5.6	7.9



### Can't find what you are looking for?

We can provide unique and customized solutions.  
Contact your nearest [Gripwell](#) team for assistance!